



# **G5** Aqua Star >>>

Coral reef / Marine fish



Timer



Night Mood



Dimmer

# User's Manual

# Specification

Item	Specification	Item	Specification
LED Brand	Epistar	Input Voltage	100-240V AC
LED Quantity	24pcs	Single LED power	3W/5W
Max power	95W ( ±5% )	Product/Lamp size(mm)	220*40*120mm
Net weight	2.00kg	Package size(mm)	390*258*78mm
Shell material	Aluminum +Plastic	Shell color	Black
Working temperature	-10℃ - 50℃	Storage temperature	-20℃ - 70℃

# LED Layout

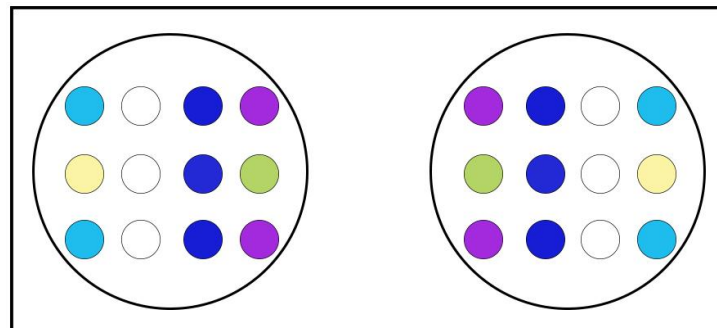

LED Channel	Color of the LED chips
Channel A	 14000K Cold White
Channel B	 450nm Royal Blue+457nm Dark Blue
Channel C	 430nm Violet blue+470nm Blue
Channel D	 420nm+410nm Purple
Channel E	 3000K Warm White
Channel F	 500nm Green

# Spectrum

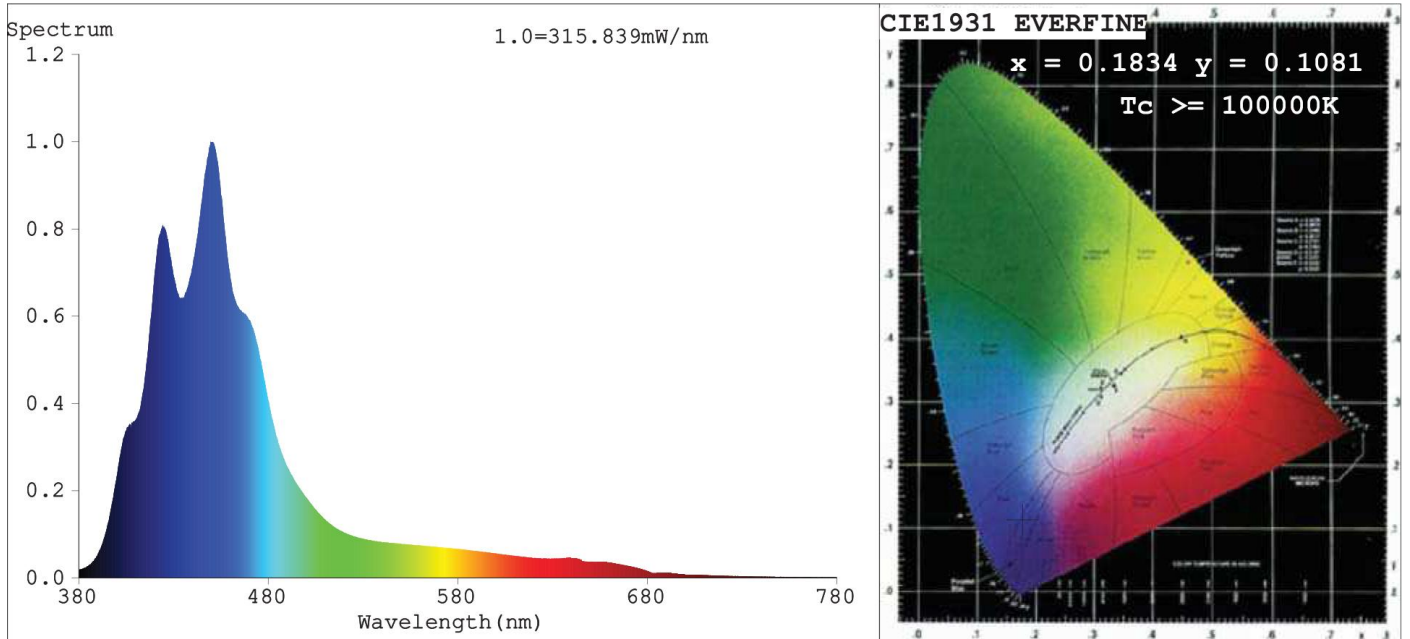

# Operation Manual

## 1. Buttons and display

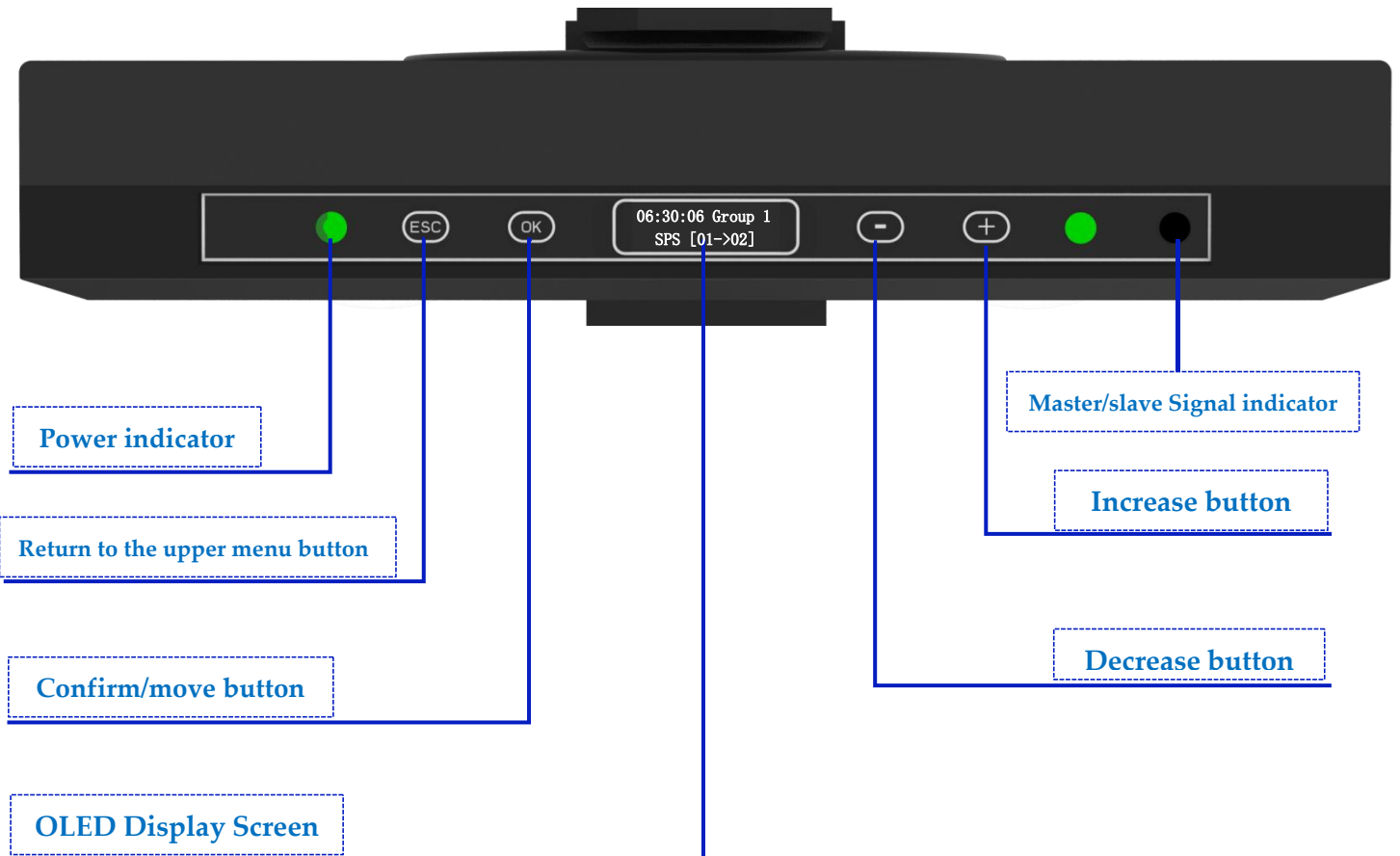

## 2. Menu Content

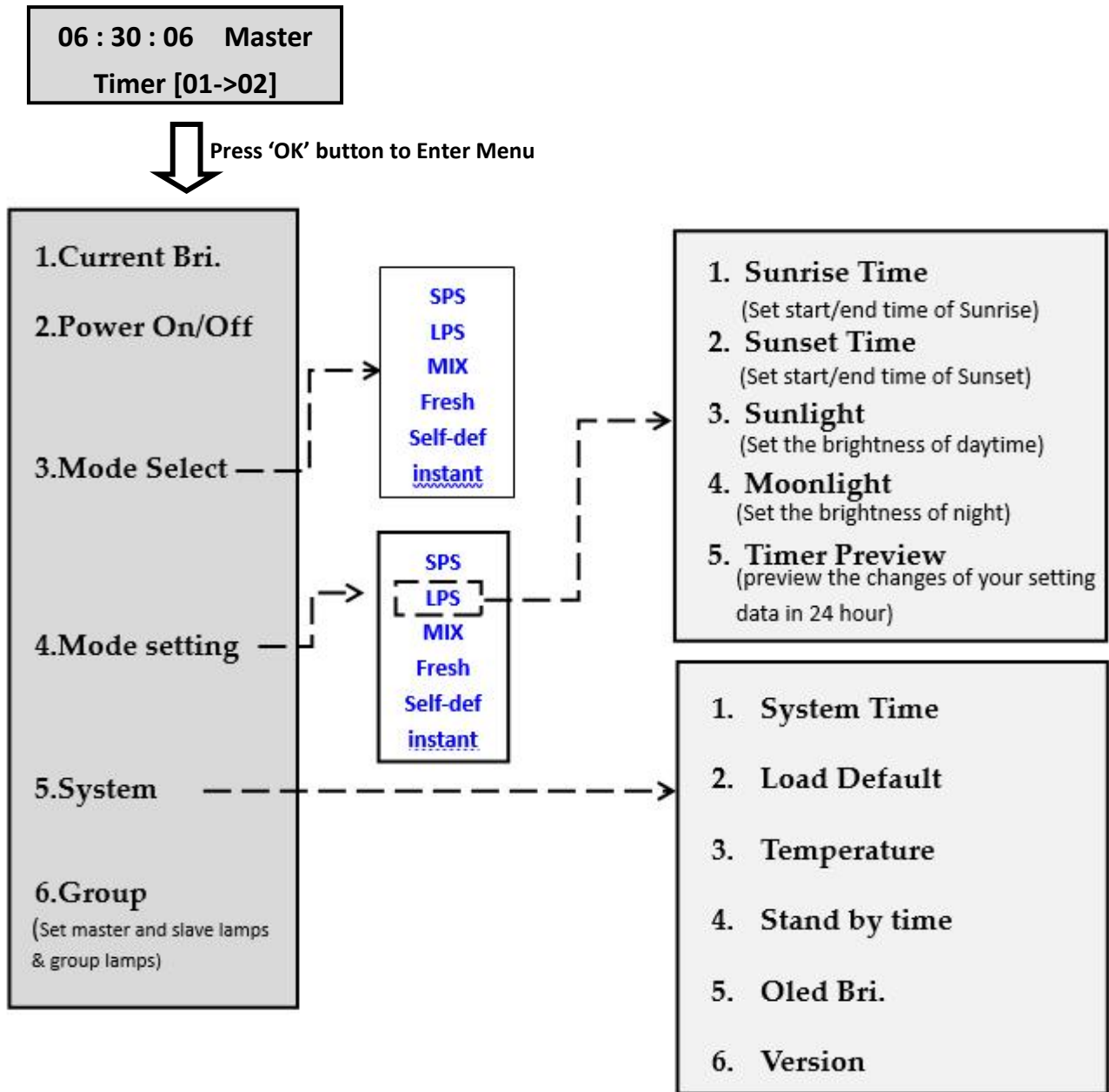

## 3. Menu Introduction

### ● OLED Display Screen

When lamps are running without any input, the OLED screen will show the lamps status as the following figures.

06 : 30 : 06 Group 1  
Timer [01->02]

Master lamp

Slaver  
Group 1

Slave lamp

For master lamps, there are two lines.

First line is the clock and master group no.

Second line shows the operation mode (such as timer or dimmer) and the current working stage.

For example, Timer [01->02], the light is running in timer mode, and working from the first time point to the second time point.

## ● **Introduction of Menu Items**

Press the “OK” button to enter the menu.

### **1. Current Bri.**

Displays the current brightness (as a percentage) of each channel.

### **2. Power On/Off**

Turn off the light without shut off the power supply.

When select power “off”, all led channels turn off.

When select power “on”, all led channels works and lamps resume normal running.

### **3. Mode Select**

User can select the different work mode such as SPS, LPS, MIX, Self-def and Instant.

### **4. Mode Setting**

User should finish mode setting before mode select. All modes except Instant support timer and brightness setting. Instant mode keep same brightness all time.

Except the instant mode, all other modes need set the data as below:

#### **> 1. Sunrise time**

Set the start and end time of sunrise (Time point 01 &02)

#### **> 2. Sunset time**

Set the start and end time of sunset (Time point 03 &04)

#### **> 3. Moon time**

Set the start and end time of Moon (Time point 04 &05). Moon time start point is same with Sunset point.

#### **> 4. Sunlight**

Set the brightness of each channels of daytime. (Time point 02 to time point 03)

#### **> 5. Moonlight**

Set the brightness of each channels of night. (Time point 04 to time point 01)

## > 6. Time Preview

Time preview function can let users to check timer mode configuration. Users can preview the changes of 24 hours running data in quick time.

Please note:

1. G5 will quickly show brightness of all channels of whole day in preview function.
2. G5 will shut down the OLED screen when no any inputs within 3 minutes to save electricity

The graph below shows the light curve of 24 hours:

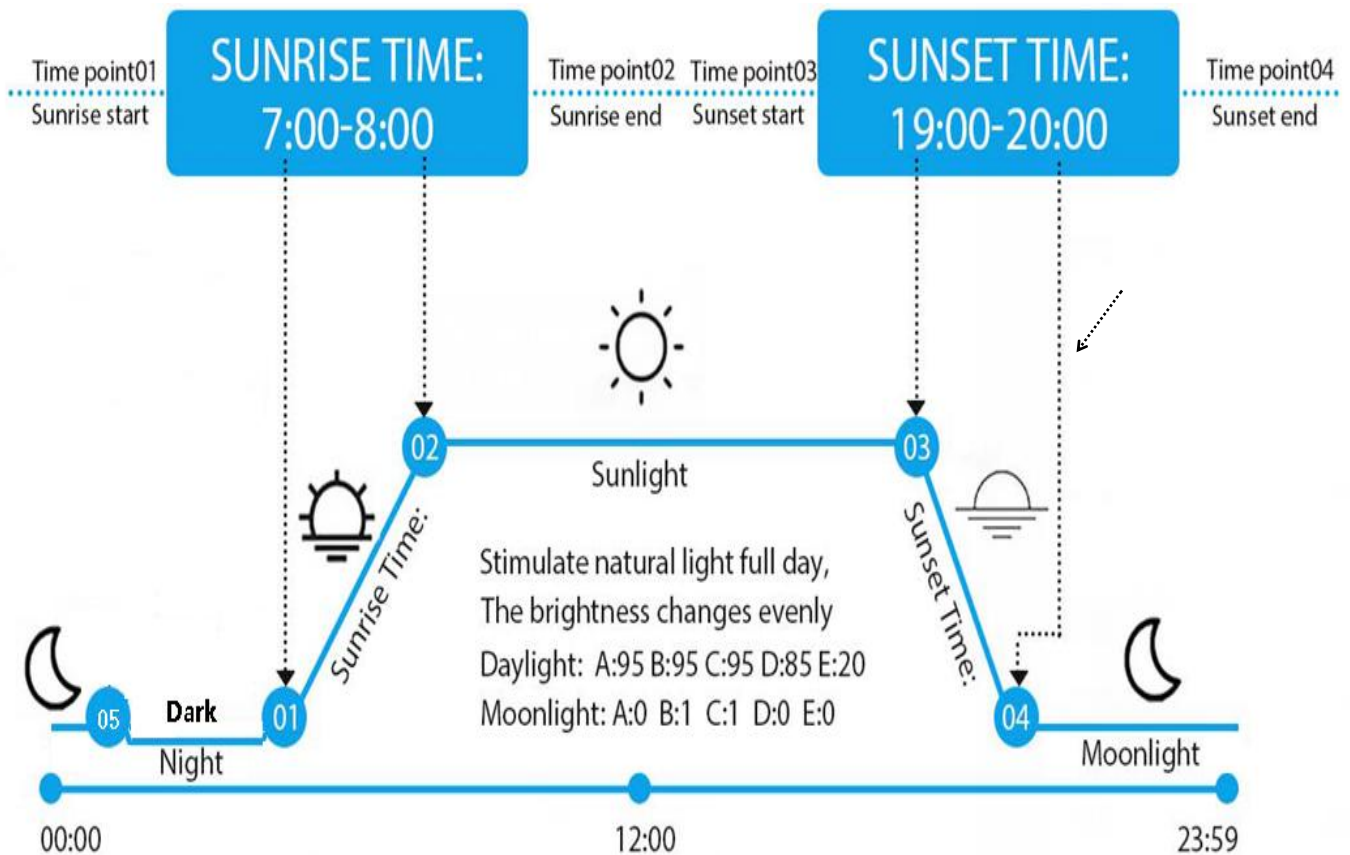

## 5. System

### > 1. System Time

Set user local time. G5 will run based on timer schedule in timer mode.

### > 2. Load Default

Clear user's setting parameters, and restore the factory default settings.

### > 3. Temperature

Shows the current time, the internal temperature of the lamp, and the working status of the fan.

### > 4. Standby time

The OLED screen will closed after the standby time (min) if no any operations.

### > 5. Oled Bri

Setting the OLED screen brightness.

### > 6. Version

The version of the light.

## 6. Group

Multiple G5 can be used in one big tank. Users can set one G5 as master and other G5 as slave with same group no. After simply setting, all slave lamps will follow master.

### 1. Master-slave lamp setup



Master: Main lamp, it will control all slave lamps in same group.

Slave: Choose [slave] mode and group no. the slave G5 will follow master G5 and no need set other parameters. It will run same with master.

The brightness/parameters of the master lamp can only be synchronized within the same group.

### 2. Group no

The master and slave lights must be in the same group, so they can be synchronized.

G5 can support maximum number of groups: 10

### 3. RF OFF

User can turn off RF if there is only one G5 in a tank. No wireless signal in house.

## 4. Remote Function



Note: Remote need install a lithium battery CR2025 3V before use.

# Recommended Operation

## 1. Set System Time

Press "ok" button and Enter "5.system" item, select "1.system time" and set to your local clock.

## 2. Enter **Mode Setting** and set sunrise/sunset time, daytime/night brightness

Press "ok" button and select "4.Mode Setting" item, press "ok" to select "sunrise" to set sunrise time, default value is 6:00-7:00. Select "sunset" to set sunset time, default value is 18:00~19:00.

Select "sunlight" to set channels brightness of daytime; Select "moonlight" to set channels brightness of night.

## 3. Enter **Mode Select** and select one mode for your tank.

4. If multi G5 lamps in one big tank, set one G5 as master, others are slave. Keep them in same group no.

5. The following is suggested setting of different tanks for your reference:

### SPS

Default Setting		Channel brightness setting						
Sunrise:	7:00-8:00	Channel name	CH1	CH2	CH3	CH4	CH5	CH6
Sunset:	19:00-20:00	Sunlight	95	95	95	85	20	20
Moon:	20:00-23:00	Moonlight	0	1	1	0	0	0

### LPS

Default Setting		Channel brightness setting						
Sunrise:	8:00-9:00	Channel name	CH1	CH2	CH3	CH4	CH5	CH6
Sunset:	19:00-20:00	Sunlight	80	80	80	20	15	15
Moon:	20:00-23:00	Moonlight	0	1	1	0	0	0

### MIX

Default Setting		Channel brightness setting						
Sunrise:	7:30-8:30	Channel name	CH1	CH2	CH3	CH4	CH5	CH6
Sunset:	19:00-20:00	Sunlight	40	90	90	75	15	15
Moon:	20:00-23:00	Moonlight	0	1	1	0	0	0

### Flesh

Default Setting		Channel brightness setting						
Sunrise:	8:00-9:00	Channel name	CH1	CH2	CH3	CH4	CH5	CH6
Sunset:	19:00-20:00	Sunlight	40	50	50	20	40	80
Moon:	20:00-23:00	Moonlight	0	1	1	0	0	0

### Self-Def

Default Setting		Channel brightness setting						
Sunrise:	8:00-9:00	Channel name	CH1	CH2	CH3	CH4	CH5	CH6
Sunset:	19:00-20:00	Sunlight	40	90	90	75	40	80
Moon:	20:00-23:00	Moonlight	0	1	1	0	0	0



# Installation

## ➤ Packing list



- |            |                       |                   |                         |
|------------|-----------------------|-------------------|-------------------------|
| 1. G5 body | 2. External adaptor   | 3. Remote         | 4. Clamp                |
| 5. AC cord | 6. Stand A (straight) | 7. Stand B (Bent) | 8. Extension fixing rod |

## ➤ Assembling Steps of Rack

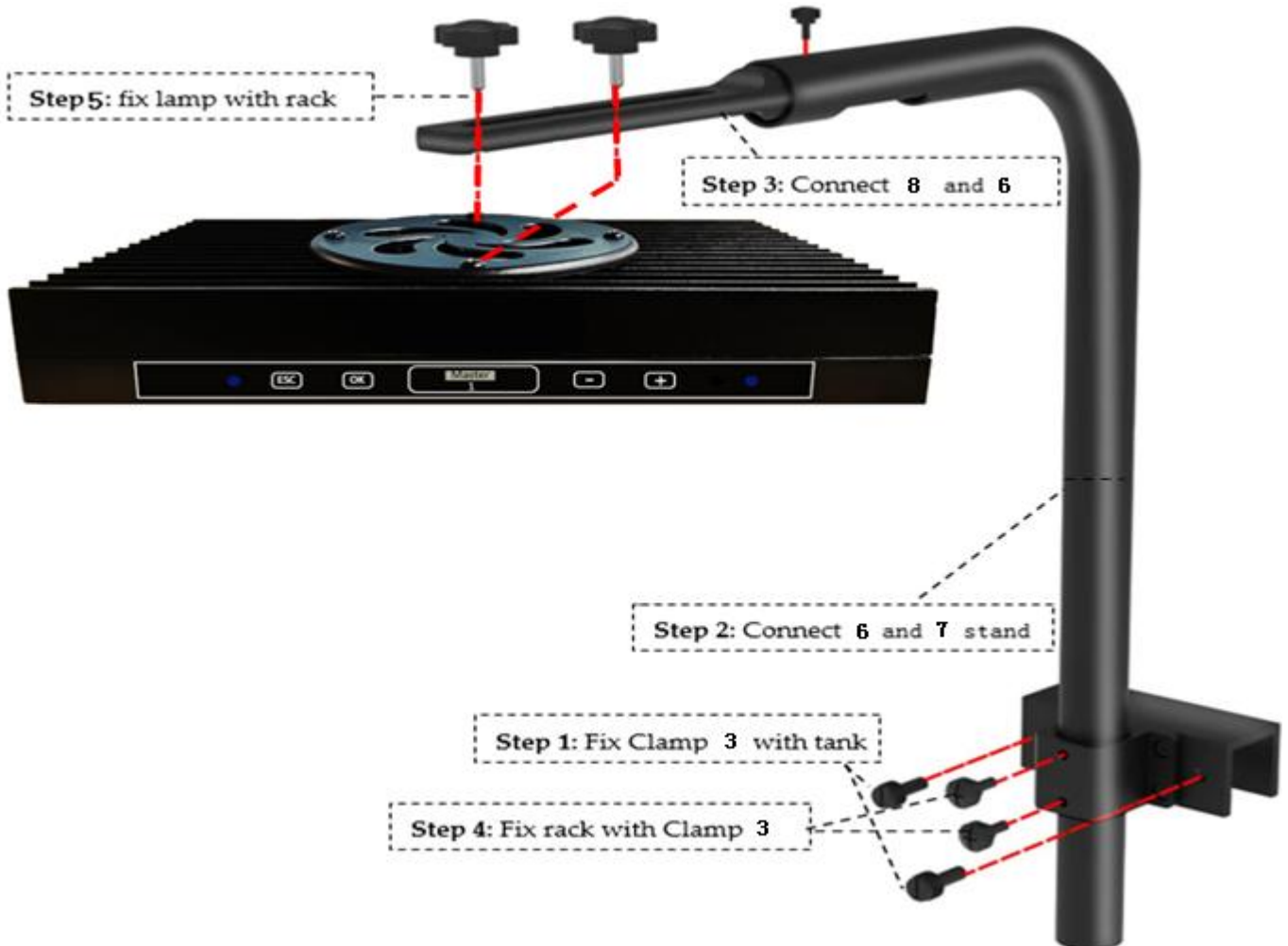

# Q&A from Customers

**Question: Does it work on a rimmed tank?**

**Answer:** Depends on the thickness of the rim. On smaller tanks up to say 55 gallons it fits easily. For larger tanks there is some creativity involved in mounting the arms. I simply notched the inside lip of the back side of my tanks frame to mount the lights.

**Question: Can you control each color intensity separately. For example blue 100, light blue 80, red 5, green 5, and white 20?**

**Answer:** There are 6 channels that can be controlled and set individually.

**Question: How many lights would i need for a standard 90g**

**Answer:** I'm going to use 2 over my mixed reef for now. If I need too I'll add either two more of these.

**Question: Why the fan of it doesn't work sometimes?**

**Answer:** It only kicks on at certain temperature, once cooled it shuts off.

**Question: How many lights do I need for a 210gl**

**Answer:** I am running 4 lights on a center braced 180 gallon 72x24x24 reef. Although it was suggested by the company that I could run 3. I have a mixed reef with sps lps and softies.

**Question: how good is the spread of these lights? does it have good par in the 24 inch diameter?**

**Answer:** Yes, it covers 24" nicely. The way the lenses are designed, there's actually a good amount of light reflected off of the glass.

**Question: What are the light settings that have worked well on your coral?**

**Answer:** I have a 72 x 24 x 24 180 gallon. I run 4 of these lights. My light settings are as follows sunlight: channel 1-8%, channel 2-35%, channel 3-40%, channel 4-35%, channel 5-5%, channel 6-5%. Moonlight all are set to 0% except channel 2-1%. My sunrise setting is from 8am to 11am and sunset is from 5pm to 8pm. I have a mixed reef. I have softies, lps, and sps and have seen measurable growth on the monti digitata and cap. I do increase my intensities by 1 percent every 2 weeks. I absolutely love these lights.

**Question: would one light work to grow Lps corals at 30in wide and 21deep and 15in wide. its a 36 gal bowfront**

**Answer:** I don't see why it shouldn't...the light spread is very wide. I have it on a IM Novu 20 (24"x13") Fusion MIXED corals...good growth...very quiet...can't even hear the fans when (or if they do) turn on.

## Contact Us

Email address: [info@ctlite.cn](mailto:info@ctlite.cn)

Email address: [jack@ctlite.cn](mailto:jack@ctlite.cn)

Website: [www.ctlite.cn](http://www.ctlite.cn)

[Ask question /QA](#) on our page